

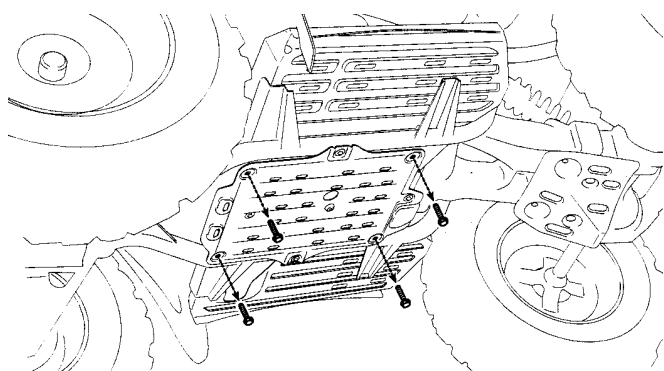

INSTALLATION
PLAQUE ADAPTEUR

1. Enlevez les quatre (4) boulons d'origine retenant la plaque protectrice au VTT (FIGURE A).
2. Fixez la partie arrière de l'adaptateur (FIGURE B, # 1) au châssis du VTT avec deux (2) brides en "U" 1 1/4" DIA. X 5" (FIGURE B, # 2), de deux (2) boulons hex. 5/16" NC x 2 1/4" LG (FIGURE B, # 3), de deux (2) rondelles plates 1/4" DIA. (FIGURE B, # 4) et de deux (2) écrous nylon 5/16" NC (FIGURE B, # 6), **sans serrage**.
3. Fixez la partie avant de l'adaptateur (FIGURE B, # 1) au châssis du VTT avec deux (2) boulons hex. 5/16" NC x 2 1/4" LG (FIGURE B, # 3), de deux (2) rondelles plates 1/4" DIA. (FIGURE B, # 4), de deux (2) rondelles plates 3/8" DIA. (FIGURE B, # 5) et de deux (2) écrous nylon 5/16" NC (FIGURE B, # 6), **sans serrage**.
4. Resserrez tous les boulons et écrous fermement.



AVANT

FIGURE A

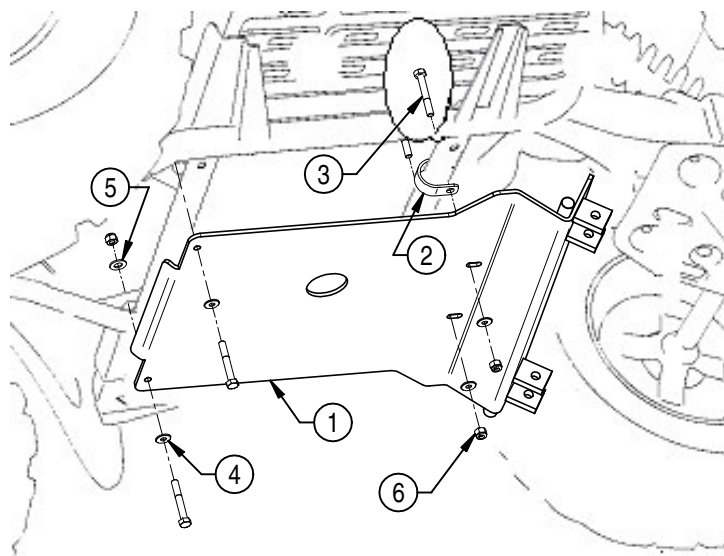

ARRIÈRE AVANT

FIGURE B

ARRIÈRE

Liste de pièces

Réf.	Description	# de pièce (OEM)	Qté.
1	Plaque adaptateur	00PS-040	1
2	Bride en "U" 1 1/4" DIA. X 5"	04PA-005	2
3	Boulon hex 5/16" NC x 2 1/4" LG	HB-5/16-18NCx2-1/4	4
4	Rondelle plate 1/4" DIA.	FW-1/4-USS	4
5	Rondelle plate 3/8" DIA.	FW-3/8-USS	2
6	Écrou nylon 5/16" NC	HLN-5/16-18NC	4



ADAPTER
INSTALLATION

1. Remove the four (4) bolts existing bolts retaining the protective plate to frame (FIGURE A).
2. Fasten the rear part of the adapter (FIGURE B, # 1) onto the frame using the two (2) U-brackets 1 1/4" DIA. X 5" (FIGURE B, # 2), two (2) hex. bolts 5/16" NC x 2 1/4" LG (FIGURE B, # 3), two (2) flat washers 1/4" DIA. (FIGURE B, # 4) and two (2) self-locking nuts 5/16" NC (FIGURE B, # 6), **without tightening** .
3. Fasten the front part of the adapter (FIGURE B, # 1) onto the frame using two (2) hex. bolts 5/16" NC x 2 1/4" LG (FIGURE B, # 3), two (2) flat washers 1/4" DIA. (FIGURE B, # 4), two (2) flat washers 3/8" DIA. (FIGURE B, # 5) and two (2) self-locking nuts 5/16" NC (FIGURE B, # 6), **without tightening** .
4. Secure all nuts and bolts.

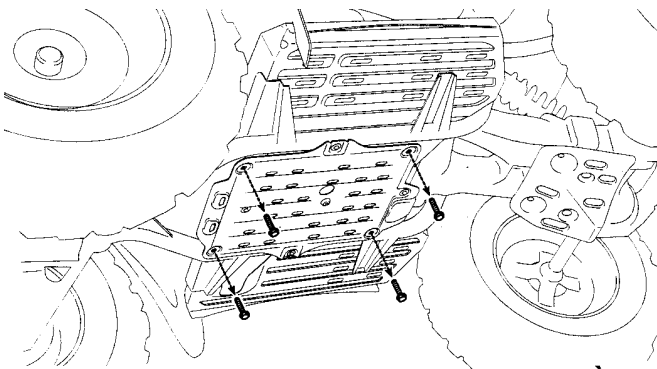

FRONT

FIGURE A

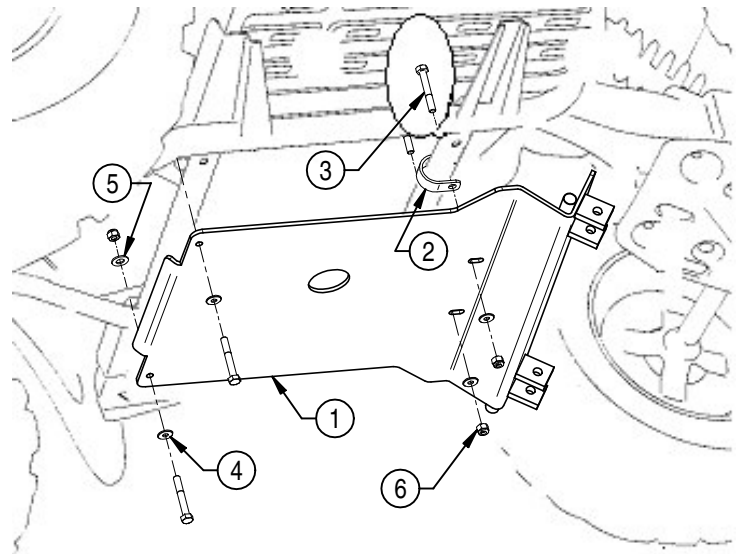

REAR FRONT

FIGURE B

REAR

Parts list

Ref.	Description	Item # (OEM)	Qty.
1	Adapter	00PS-040	1
2	U-bracket 1 1/4" DIA. X 5"	04PA-005	2
3	Hex. bolt 5/16" NC x 2 1/4" LG	HB-5/16-18NCx2-1/4	4
4	Flat washer 1/4" DIA.	FW-1/4-USS	4
5	Flat washer 3/8" DIA.	FW-3/8-USS	2
6	Self-locking nut 5/16" NC	HLN-5/16-18NC	4