



OWNER'S MANUAL



Revised august 2005

TABLE OF CONTENTS

	Page
Introduction	1
Advice to buyer	2
Safety precautions.....	3-4
Tips and tricks	
Emergency tools.....	5
Installation	6-7-8
Alignment.....	8
Track tension.....	9
Lubricating	9
Storing / Maintenance.....	10
Parts list	see annex A
User notice and disclaimer	11-12

TECHNICAL ASSISTANCE

If a problem concerning the warranty of your TATOU system should arise, and if your local authorized dealer cannot solve it, please contact us. 1-888-533-0008. From 8 am to 5 pm, monday to friday eastern time.

INTRODUCTION

Congradulation on choosing the quality **Tatou** tracks system, conceived to bring you many days of enjoyment during your wintery excursions.

Please read this owner's booklet carefully, it will answer all the questions you may have concerning this product. It is also very important to read your ATV's owner manual and follow all the safety requirements. These rules also apply to your **Tatou** tracks.

Consult with your local, provincial or national authorities about the regulations pertaining track equipped vehicles. You should also get informations from off-road vehicles clubs concerning the use of tracks on their estates.





ADVISE TO BUYER

This owner's manual has been carefully drafted in order to allow an easy installation of **TATOU track system**.

 **Please read entirely this owner's manual.** It will allow you to become better acquainted with the **security recommendations, the assembly procedures and the proper functioning of the tracks.** It is also advisable to communicate this information to **anyone who will use this equipment.** When transferring or selling the track, transfer the manual too.

 TATOU cannot be held responsible for the changes that the use of track could bring to the handling of the vehicle.

 Even when equipped with track, it is important to respect the towing capacity specified by your vehicle manufacturer and all the recommendations regarding the stability warnings that are mentioned in the ATV's owners manual.

 Do not ride over stumps and branches, or on rocky ground, as this could damage the tracks or their mechanisms and even could get you stuck.

 Familiarise yourself with riding with your Tatou tracks. It rides differently than with wheels.

 While driving into wilderness, please respect the environment and avoid damaging plants or disturbing wildlife.

Note : In this booklet the right and left-hand sides of your Tatou tracks are determined while you are sitting on your ATV.

Important : Tatou Traction have been designed exclusively for winter riding, on at least 12 " of snow.

Important notice :

Before you start assembling the Tatou track system, please make sure you have Annexe A that belongs to your type of ATV.



TATOU

Note : All the drawings in this manual represent the latest information available at the time of publishing and are subject to change without previous notice.



This symbol points out that the misuse of the Tatou tracks could result to a potential break down of this product.

THIS SYMBOL MEANS



THAT THERE IS A DANGER TO YOUR SAFETY OR OTHERS

SAFETY PRECAUTIONS



Never try to adjust the track if the engine is running or if the parking brake is not on.



Regularly inspect all nuts and bolts, and tighten them if necessary to avoid costly repairs.



To prevent injuries, it is recommended to avoid wearing large clothes or too long scarf that could be engaged in the tracks.





IMPORTANT NOTICE :

the Tatou track system will take you to places unaccessible until then. Make sure you know the limits of your vehicle before going to places, far out of the usual way.



The following safety precautions are important to help you avoid accidents. In order to prevent injuries, read the safety advices carefully before installing and using your tracks.



Even when equipped with tracks, only the driver may ride on the vehicle (see the vehicle's owner's manual, and provincial or national regulations).



Never allow a child to drive the vehicle (see road regulations and vehicle's owner's manual), nor an adult who has not received proper training.



Never let anybody use the vehicle while under the influence of alcohol, drugs or medications.





Make sure nobody's hands and feet come near your Tatou tracks while they are moving, this could cause serious injuries.





Tips and tricks while riding

In deep snow conditions **do not** spin your tracks, or you are liable to get stuck. If this does occur, stop, back up slightly and go forward slowly.

-  Make sure the guide wheels and the tracks don't freeze.
-  Before every ride, de-ice the components of the tracks.
-  The slower you go, the better traction you have.

Emergency tools

Two wrenches 5/8 or 16 mm for track tension
Two wrenches 1/2 or 13 mm for the guide wheels
An axe and a shovel

-  **If you are going into unknown territory, bring a first aid kit, a cell phone, a small axe, and emergency tool kit, tow cable and a set of spare guide wheels.**
-  **Ride carefully, the snow may hide obstacles such as stones, stumps, fences and other objects that could be dangerous.**



INSTALLATION

- ▽ Stop engine and remove key before installing the track on your vehicle in order to avoid asphyxiation by exhaust gases.
- ▽ Wear adequate working clothes during installation : safety glasses, shoes and gloves.
- ▽ While installing your tracks, avoid spinning them with engine power.
- 👉 Make sure that the tracks have the correct tension to ensure the correct position on the guiding wheels.

For installing the track on your vehicle, choose an area with a clean and leveled floor, well lit and ventilated. Put it in neutral. Shut off the engine, remove key, apply the parking brake and block the set of wheels which will remain on the ground with chocks or wedges.

Generally, you might have to shorten the lower part of the fender and make a rounded design at the mating point of the footrest.

First, identify the rear and front tracks, as well as the right and left sides.

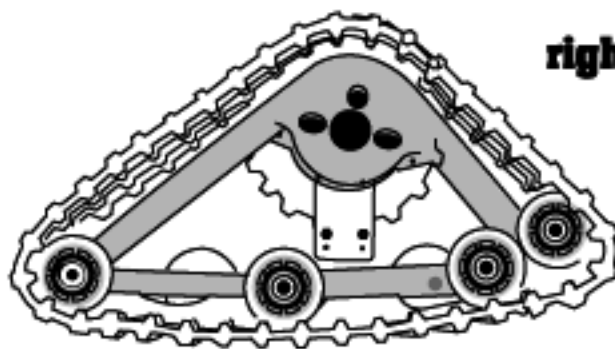

FLAT TRACK

Back

right side

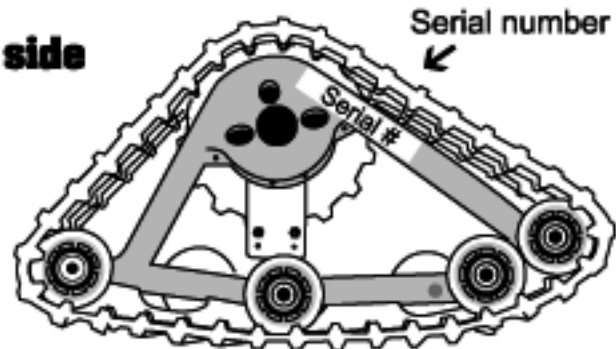

FLEX TRACK

Front

REAR TRACK

1. Install wedges on both sides of the front wheels, raise the rear of the vehicle with a proper jacking device, choosing a stable point of support.
2. Install the adapting plate(s) under the vehicle. They differ depending on the make and model of your vehicle (see Annex A)

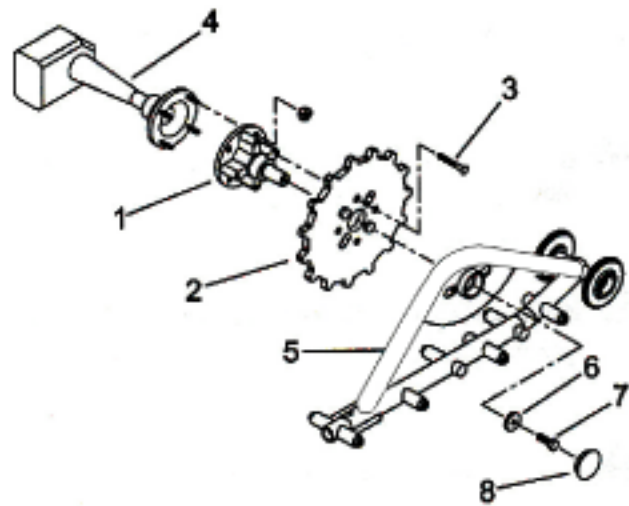

FIGURE 1

3. Install the assembled rear traction frames on to the ATV axle hub fig.1 #4, secured by the O.E.M. wheel nuts that applies to the most ATV models and tightened at the torque specified in the ATV owners manual. See annex A for specifications on using O.E.M. wheel nuts for other models.

4. Fit the anti-pivot guide fig.2 #8 with a washer 3/8 fig.2 #10 followed by a bushing 1/4 length. fig.2 #7. Insert the anti-pivot guide in the hole of the J plate followed by a washer 3/8 fig.2 #10 and locknut fig.2 #9. Must be torque to 25 foot pds.

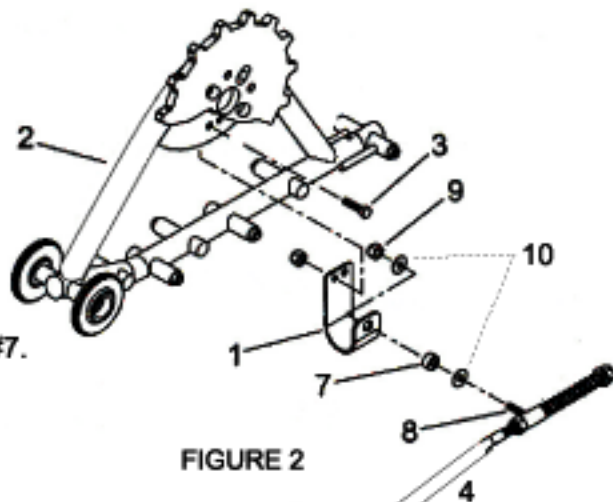

FIGURE 2

5. Fit the stabilizing rod fig.2 #4 to the adapting plate under the vehicle fig.3 #5 with the hex bolt 3/8 - 16 x 1 1/2 " fig.3 #6 using 2 flat washers fig.3 #10 followed by the bushing 3/8 length fig.3 #7, then install the arm #4 secured with flat washer 3/8 #10 and locknut 3/8-16 torqued to 25 foot pds.

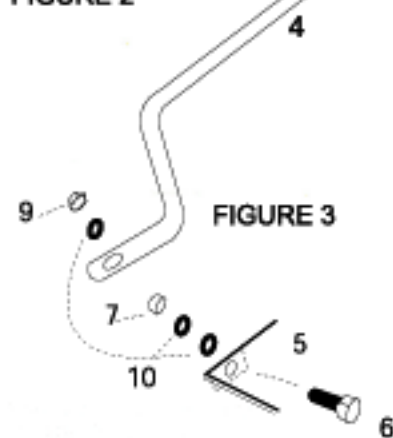

FIGURE 3

6. Refer to fig.4 : first insert the adjustment rod into the guide tube fig.4 #1 of the rear adjustment. Then insert the holding block fig.4 #4. Now you can get the track over the frame starting by the front wheels, then over the sprocket, finishing with the rear.

7. Insert the aluminum shaft fig.4 #5 into the rear wheel axle. Install the rear wheels and secure them with a washer 5/16 x 1 1/4" fig.4 #7 and fastened with a bolt 8 x 1.25 x 20 fig.4 #6. Tightened them to 19 foot pds. Using threads locker.

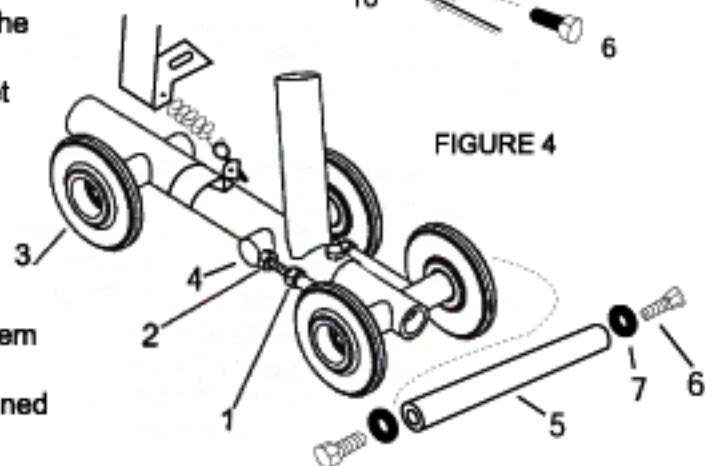

FIGURE 4

INSTALLATION OF THE FRONT TRACK

1. Install wedges on both sides of the back track and raise the front of the vehicle with a proper jacking device, choosing a stable point of support.
2. Remove the two axle boot protectors from the lower arms of the suspension.
3. Install the assembled traction frame on their respected side using the OEM wheel nuts or otherwise describe in annex A.
4. Fasten the anti pivot plate of the trail-arm (FIGURE 6, #1) to the retaining plate (FIGURE 6, #2) with two 3/8 NC x 1 1/4 LG bolts (FIGURE 6, #3) and two 3/8 - 16 NC nylon nuts.
5. Install the fastening hex bolt fig.6 #8, 3/8 - 16 x 2 1/2 into the anti pivot braket then insert it in the slot of the anti pivot plate, after install bushing #7 flat washer #10 and nut #9. Torque to 25 foot pds.
6. Get the braket fig.6 #4 to be inserted in the lower arm fig.6 #5 of the suspension and fasten it with cover #4a and bolt 3/8 - 16 x 2 1/2" and 3/8 x 16 nylon nut. Torque : 15 - 19 foot pds.
7. Repeat items 6 and 7 of rear track installation to have the track installed over the frame.

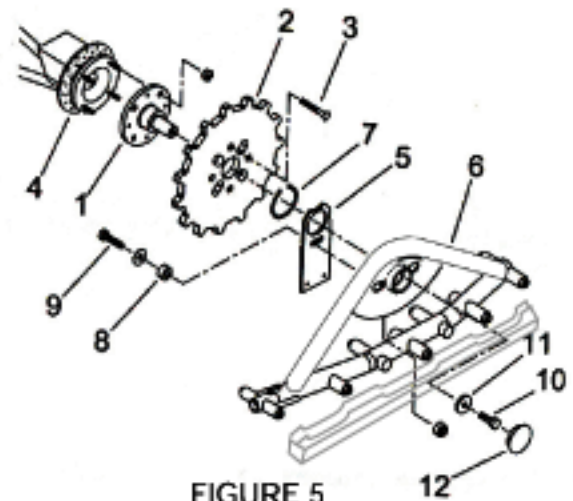

FIGURE 5

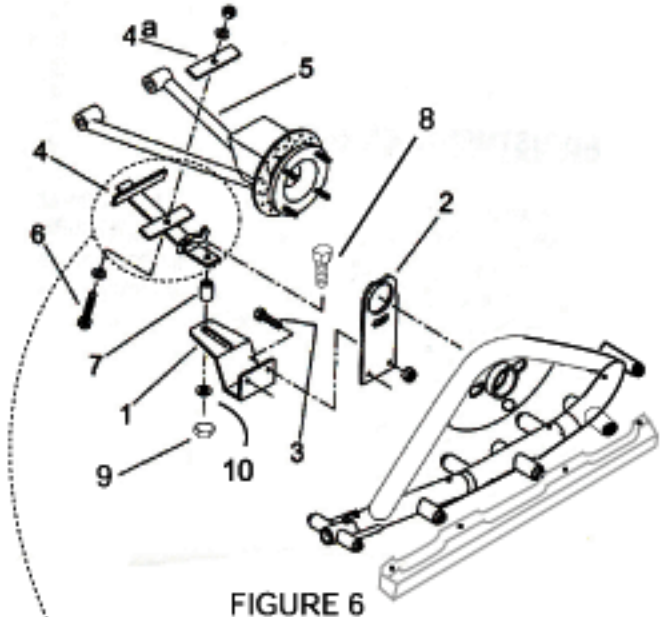
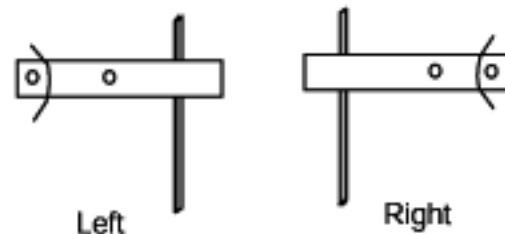

FIGURE 6



FIXATION GUIDE



Track tension adjustment

Verify the tension by applying on the long part, and at the middle point of the track a pressure of 18 to 22 pds. This should give you a deflection of approximately 1 inch/30mm (you can use any straight edge to measure the distance).

For adjustment, tighten the nut located at rear lower side of the Tatou frame (use two 5/8 wrenches). This will give you ideal track tension.

Fig 5 front right side view

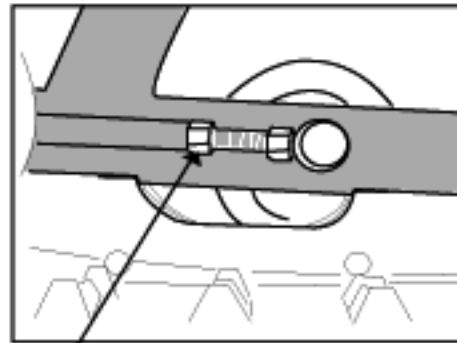
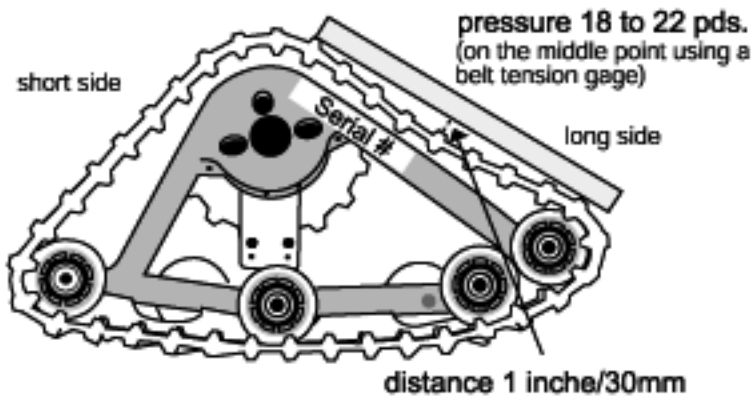

Track adjustment nut

Adjustment of the rear anti-pivot arm

Ensure that the ATV is on leveled ground, then adjust the nut fig.7 #1 in a way that it just contact the guide tube # 2 fig.7.

Then, you adjust the rear nut #4 in a way that it will compress the spring #3 by one full turn. That is to keep a pressure from the rear of the track on the ground.

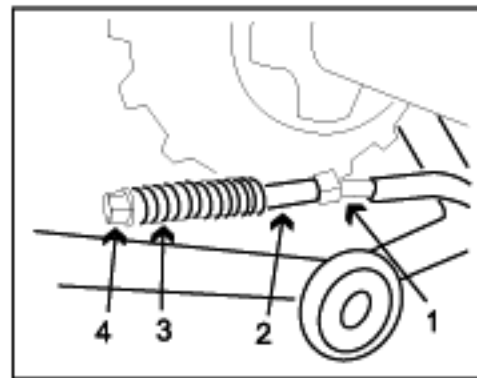

fig. 7

Lubricating



Verify the sprocket bearings each season.

Lubricate all four anti-pivot at the beginning of each new season.

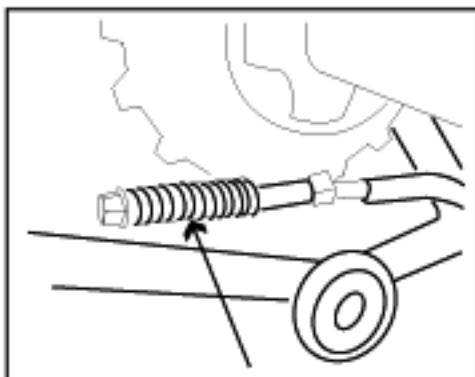

Lubricate the threads with grease.

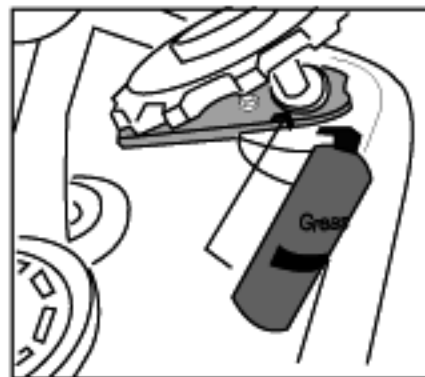

Lubricate anti-pivot plate under the sprocket with grease (a chain lube).

Dismantling and storing



Removing from your ATV: use the same safety rules as for the installation and start by removing the front traction.

After dismantling, it is highly recommended to store your Tatou tracks flat, in a dry cool place. Away from the sun.

Maintenance



Before making any adjustment or repairs to your Tatou tracks or to your ATV, stop the engine and remove the key.



It is highly recommended to replace all broken parts with original Tatou parts. This should keep your Tatou track from deteriorating. Just ask your local dealer.

Alignment

1. After putting your ATV on the ground, make the suspension bounce two to three times in order to stabilise the tracks and drive it forward for about ten feet and then measure.

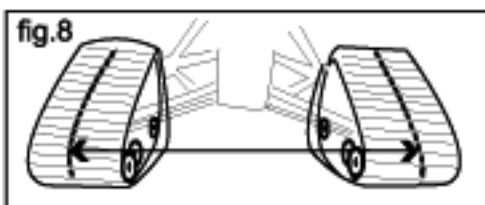

Front end of the front track

2. Using the center hole of the track, measure the front end of the front tracks (fig.8) they should be 1/2 " less wide than the back ends (fig.9).

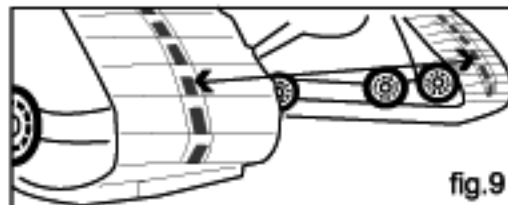

Rear end of the front track



For a better driving condition, make you should re-check the alignment after the "first" ride of each new season.

Warranty

TATOU warrants this product against any defect that are due to faulty material or workmanship for one season in winter conditions only. This warranty does not include damage to the product resulting from accident, misuse, or repairs performed by unauthorised people. If the product should become defective within the warranty period, or you have questions regarding warranty or service, call consumer assistance and information toll free 1-866-533-0008.



USER NOTICE AND DISCLAIMER

This document contains important information regarding the handling of all terrain vehicles (ATVs) equipped with the Tatou Track System (hereinafter referred to as the "System".) It is of great importance that all users of ATVs equipped with the System carefully read this document and consult the ATV's user guides and manuals. Upon purchasing either a new or used System, ensure that you have obtained all of its pertinent documentation and, where relevant, documentation related to the ATV on which the System is installed, including without limitation user guides and manuals, maintenance booklets and repair bills. If needed, contact the Tatou dealer closest to you for additional information. You may also visit the Tatou Web site or contact a customer service representative by e-mail at info@e-tatou.com, or by phone at 1-866-533-0008.

Tatou inc. believes there are risks associated with the installation and usage of the System. While experience demonstrates that the System is safe and secure, ATV operators must be aware of the inherent risks of handling such a vehicle, and of the specific characteristics involved with the System's installation. Operators of ATV equipped with the System must, at all times, conform to applicable laws and regulations and to manufacturer's specifications regarding both the System and the ATV, notably in terms of the minimum age for handling ATVs, and in terms of all additional equipment such vehicles must be fitted with (headlights, standing and brake lights, rear-view mirror, etc.) ATV users must also wear the adequate protective gear, including a certified helmet, visors, clothing, boots and gloves. It goes without saying that consumption of intoxicating substances, including alcohol, presents a clear danger for ATV users.

The System is comprised of a number of moving parts, including driving wheels. Should an attempt be made to dislodge a foreign object embedded within the System and impeding its proper functioning, it is recommended that the ATV's power be cut to prevent any sudden and abrupt movement of the vehicle, or of its moving parts, which could bring about serious injury. In addition to this, the wearing of large clothing, such as long scarves, can lead to a serious injury should the garment get stuck in any of the System's components.

Driving an ATV equipped with the System requires the right precautions and an understanding of driving techniques associated with this type of vehicle. The ATV operator's knowledge of terrain condition (slippery ground, slopping, snow density, etc.) is equally important. An ATV equipped with the System is not an appropriate vehicle with which to compete or to perform skill-testing feats, acrobatics, stunts or other exploits. Such manoeuvres can lead to a loss of control. Insufficient control of the ATV during a descent, a climb, a sharp turn or the clearing of an obstacle can result in an injury-causing or fatal roll over. Also, transporting passengers, cargo or a trailer can throw an ATV off balance and limit the driver's control. Unless specified by the ATV's manufacturer, never transport passengers.



USER NOTICE AND DISCLAIMER (part two)

The System is designed for 4-wheel drive ATVs from North America's main manufacturers, including Arctic Cat, Bombardier, Honda, John Deere, Kawasaki, Kubota, Land Pride, Polaris, Suzuki and Yamaha. The System must never be installed on 2-wheel drive ATVs, whether as a replacement for the driving wheels only or the driving wheels and the steerable wheels.

Installing the System can have significantly different impacts on the behaviour of various ATV brands and models. It is therefore imperative that drivers having acquired experience in handling ATVs equipped with the System adapt their driving behaviour accordingly when getting behind the handlebars of other models equipped with the System.

The System is designed primarily for use on snow-covered surfaces. Tatou tracks offer a much greater surface contact area than regular tires. The ground pressure per square inch is thus considerably reduced which, in turn, impacts the behaviour of an ATV equipped with the System.

In general, ATV stability is dictated by the ATV's centre of gravity along with the interaction between driver and vehicle. Installing the System can modify an ATV's centre of gravity by increasing its overall height and unladen weight. Altering the centre of gravity can have an effect on the ATV's behaviour and thus requires that its handling be adapted accordingly. Due to the increase in height of the vehicle, the driver must also exercise caution when travelling underneath obstacles. In addition, installing the System typically results in an increase of the overall width of the ATV. The driver must therefore exercise cautions when negotiating narrow passages, or when meeting other vehicles.

By design, the System can significantly reduce the ATV's top speed and distort a proper reading of the speedometer. In general, the diameter of the System's driving wheel is smaller than that of the original tire, in which case the speedometer reading will be greater than the actual speed of the vehicle. The driver of an ATV, whether equipped with the System or not, must always adapt the vehicle's speed to both weather and terrain conditions. Plus, the driver must never exceed the limit imposed by his or her level of ATV training and experience, as excessive speed remains a leading cause in ATV-related accidents.

Tatou Track Systems have been commercially available for several years. A number of users have installed these systems for utility, commercially-oriented purposes, thus subjecting them to rigorous and intensive usage. A number of users have also installed them for recreational purposes. The Tatou company is proud of the safety record established through the System's many uses over the years. Nonetheless, there are inherent risks associated with operating an ATV that is equipped with the System. It is therefore necessary that ATV operators become familiar with handling techniques, that driving itself be adapted to one's level of experience, and that a constant awareness of terrain conditions be applied to ensure a safe and secure enjoyment of Tatou products.

